

VIENNA MULTI DECK WITH DOORS

PROJECT: _____
ITEM: _____ QUANTITY: _____

MODEL # VICD-58-R-SQ-SC-INS-HD

SPECIFICATIONS

The Vienna Multi Deck series with doors offers a larger capacity of display with a compact footprint at an incredible value! Full insulated glass front hinged doors and glass sides.

Available lengths: 31 1/2" 44 1/4"
Available depths: 29 3/8"
Available heights: 86"



STANDARD FEATURES

- Squared Glass Profile
- 304 Stainless Steel Exterior
- Hinged Insulated Glass Front Doors
- Insolated Glass Side Panels
- Programmable Digital Refrigeration Controller
- Energy Efficient LED Lighting
- Self-Contained Refrigeration
- Front Bottom To Rear Air Ventilation Kit
- Fan Assisted Cooling System (Fan Speed is Adjustable)
- 3 Adjustable Glass Shelves With Price Tag Holder
- Lift-Up Evaporator
- ETL Listed in Accordance with UL 471 and NSF 7 Standards
- Environmentally Safe Refrigerant
- 5 Year Compressor Warranty
- Automatic evaporation via hot gas

OPTIONAL FEATURES

- RAL 9005 Matt Deep Black Powder Coat
- Other RAL Colors (Contact Factory)
- Health Door

NOTE: Leg levelers need to be adjusted to 4" in height to accommodate loose toe kick & proper air intake.

MODEL	L	D	H	VOLT	AMP	PLUG	WT	REFRIG.
VICD2-58-R-SQ-SC-INS-HD	31 1/2"	29 3/8"	86	115	7.9	5-15P	715	R448A
VICD3-58-R-SQ-SC-INS-HD	44 1/4"	29 3/8"	86	115	12.9	5-20P	825	R448A



Conforms to UL Standard 471, and NSF Standard 7; Certified To CSA Standard C22.2 No.120

CALL TOLL FREE: 800-525-3692 (609-714-2330)

FAX: 609-714-2331 www.rpiindustries.com

220 ROUTE 70, MEDFORD, NJ 08055

RPI INDUSTRIES, INC. v5_2_24

VIENNA MULTI DECK WITH DOORS

PROJECT: _____

ITEM: _____ QUANTITY: _____

MODEL # VICD-58-R-SQ-SC-INS-HD

VICD2-58-R-SQ-SC-INS-HD

VICD3-58-R-SQ-SC-INS-HD

12" ← Minimum unobstructed clear space required for air discharge. → 12"

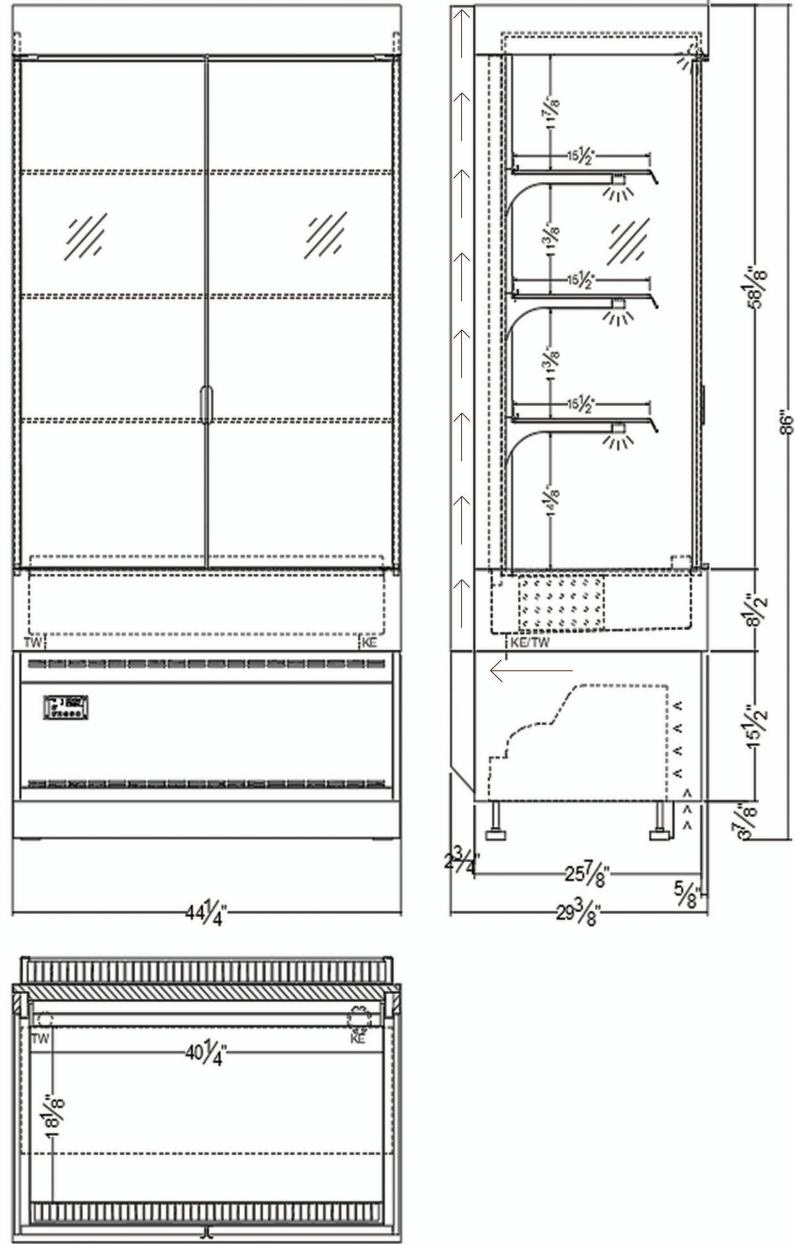
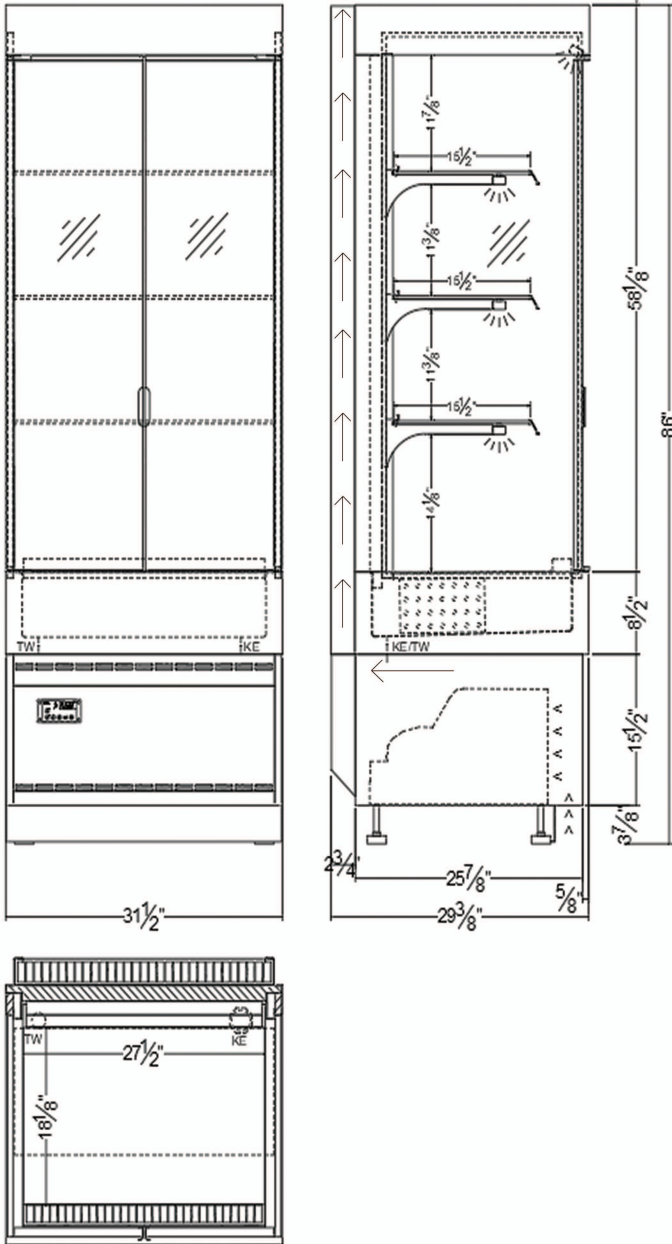

The VICD merchandiser is designed for use in locations where temperatures and humidity do not exceed 75 degrees and 55% R.H. Locate away from direct sunlight, rapid air currents and extreme temperature changes. Exposure to air currents from ceiling fans, air conditioners, ovens, etc. will disrupt the cases air current and refrigeration zone within. Any adverse field conditions stated above will void warranty.

RPI in line with it's policy to continually improve it's product reserves the right to change materials and specifications without notice.

CALL TOLL FREE: 800-525-3692 (609-714-2330)

FAX: 609-714-2331 www.rpiindustries.com

220 ROUTE 70, MEDFORD, NJ 08055

RPI INDUSTRIES, INC. v5_2_24